

# Individual Safety Light Barrier Control Unit

## SS2-00VA000R2

Part Number



- Connection of up to 4 through beam sensors
- Monitoring of external safety relays
- Potential-free safety relay outputs

### Technical Data

#### Electrical Data

Supply Voltage	24 V DC
Current Consumption (U <sub>b</sub> = 24 V)	< 260 mA
Response Time	< 30 ms
Temperature Range	0...55 °C
Safety Output	Relay
No. Safety Outputs (OSSDs)	2
Switching Output Voltage Drop	< 3 V
PNP Switching Output/Switching Current	< 100 mA
Relay Output/Switching Current (250 VAC)	2 A
Reverse Polarity Protection	yes
Protection Class	II

#### Mechanical Data

Housing Material	Plastic PA
Degree of Protection	IP20
Connection	Screw Clamp

#### Safety-relevant Data

Safety Category (EN ISO 13849-1)	2
Performance Level (EN ISO 13849-1)	PL d
PFHd	3,16 × E-7 1/h *
Safety Integrity Level (EN 62061)	SILCL2

#### Function

Restart Inhibit	yes
Contact Monitoring	yes

Connection Table No.

**36**

Control Panel No.

**S8**

\* PFHd for control incl. 4 SL2

The individual safety light barrier control unit is used to monitor up to 4 through-beam sensors. Interruption of any single beam results in deactivation of the safety output.



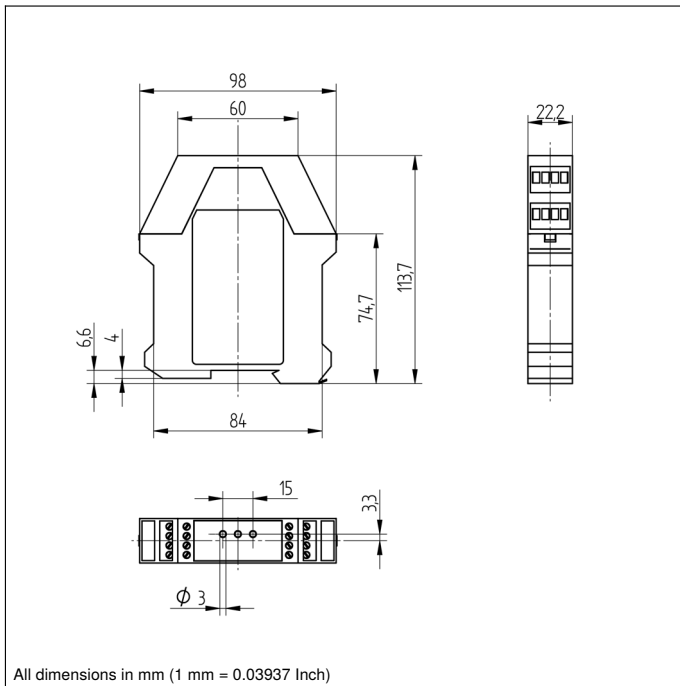

#### T10<sub>d</sub> depending on the strain

Data for SS2-00VA000R2 with up to 4 pairs of Safety Through Beam Sensors SL2

	Switching Intervall	Strain	
		Medium: 220d/a, 16h/d	Strong: 330d/a, 16h/d
2 A at 230 V AC	30 s	1,89 a	1,26 a
	1 min	3,79 a	2,53 a
	5 min	18,94 a	12,63 a
	10 min	> 20 a	> 20 a
	1 h	> 20 a	> 20 a
	8 h	> 20 a	> 20 a
0,5 A at 24 V DC	30 s	0,95 a	0,63 a
	1 min	1,89 a	1,26 a
	5 min	9,47 a	6,31 a
	10 min	18,94 a	12,63 a
	1 h	> 20 a	> 20 a
	8 h	> 20 a	> 20 a

#### Ctrl. Panel

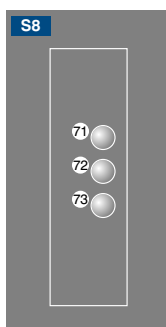

71 = Channel 1  
 72 = Channel 2/Error Indicator  
 73 = OSSD/Diagnosis

#### Complementary Products

Through-Beam Sensor SL2-00NS000H2/SL2-00NE000H2  
 Through-Beam Sensor SL2-00TS000H2/SL2-00TE000H1