

Weitergabe sowie Vervielfältigung dieses Dokuments, Verwertung und Mitteilung seines Inhalts sind verboten, soweit nicht ausdrücklich gestattet. Zuwiderhandlungen verpflichten zu Schadensersatz. Alle Rechte für den Fall der Patent-, Gebrauchsmuster- oder Geschmacksmerkmalen vorbehalten. © Pfisterer
 The reproduction, distribution and utilization of this document as well as the communication of its contents to others without explicit authorization is prohibited. Offenders will be held liable for the payment of damages. All rights reserved in the event of the grant of a patent, utility model or design. © Pfisterer

Höchste Spannung für Betriebsmittel (Um) highest voltage for equipment (Um)					145kV	
Silikon Muffenkörper joint sitze	entspricht ca. Leiterquerschnitt conductor cross- section (approx.)	Totalgewicht ohne Kabel (ca.) total weight without cable (approx.)	Kabelisolation ø geschält ø of cable insulation prepared [mm]		L [mm]	D [mm]
			min	max		
B1 - B4	1600mm ²	29kg	52	86	2300	230
B5 - B6	1200 - 2500mm ²		86.1	122	2300	260

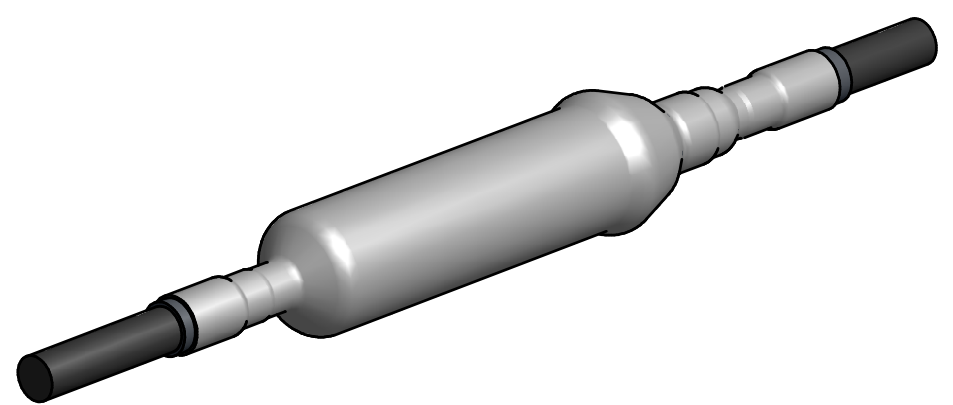
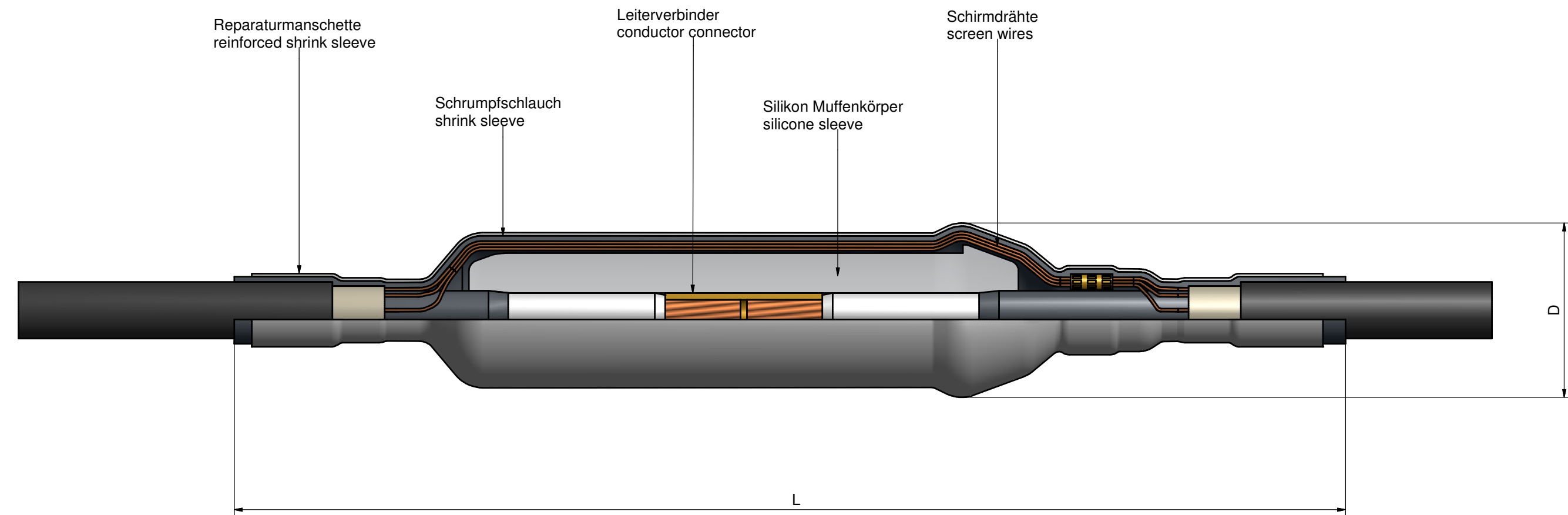

Maßstab / scale 0.24:1 (0.22:1)	Gewicht ca. / weight ca. (g) 29000	Beschreibung / title MSA145-DOR Einteilige Aufzieh-Muffe MSA145-DOR one piece slip-on joint			
Erstellt von created by GubisM	Datum / date 2015-06-20				
Geprüft von approved by Kempfu	2015-06-20				
PFISTERER		Ersatz für / replacement for	Dokumentart / type of document	Datenname / filename	Format / size
PFISTERER Ixosil AG Switzerland		Für Kunden	S04-130648	A2	Blatt / sh. 1/1
And.nr. / rev. no. 1204	And.datum / date of issue 2017-11-06	Name / name tanner	Index / rev. 06	Dokumentnr. / document no. PRO2097	

Technical data of MSA145-DOR / DOR-OP

HV one piece silicon rubber joint with reinforced shrink sleeve

Manufacturer	PFISTERER
Type designation	MSA145-DOR
Application	screen transition
Applied standard	IEC 60840

Electrical levels (IEC 60840)	
Rated voltage (U)	132 - 138 kV
Highest voltage (Um)	145 kV
(Uo) for determination of test voltage	76 kV
Max. design voltage to ground	84 kV

Electrical typ test levels (IEC 60840)	
AC withstand voltage 15 min	190 kV
Lightning impulse voltage test (BIL)	650 kV
Heating cycles (AC voltage, 2Uo)	152 kV
Partial discharge test < 5pc at 1.5 Uo	114 kV
Sectionalizer BIL (to ground)	37.5 kV
Sectionalizer DC 1 min (across shield)	25 kV

Electrical routine test levels (IEC 60840)	
AC withstand voltage 30 min	190 kV
Partial discharge test < 5pc at 1.5 Uo	114 kV
Each stress cone routine tested	yes

Current conditions	
Max. current rating	same as cable
Max. thermal short circuit current (1 s)	63 kA
	max. same as cable

Stress control	
Field control method	geometrical
Type	pre-molded
Material	silicone rubber
Production method	injection moulding
Production environment	clean room

Outer joint protection	
Inner protection	standard shrink sleeve
Outer protection	glass fibre reinforced shrink sleeve

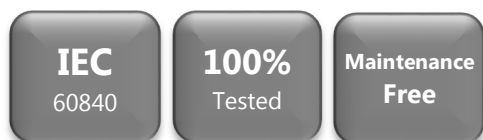

Connector	
Material	copper or aluminium
Conductor range (joint size B1 – B4)	≤1600 mm ²
Conductor range (joint size B5 – B6)	1200 - 2500 mm ²
Connection methods	
Bolted	≤2500 mm ²
Compression	≤2000 mm ²

Dimensions	
Length L (joint size B1 – B4)	2300 mm
Diameter D (joint size B1 – B4)	320 mm
Length L (joint size B5 – B6)	2300 mm
Diameter D (joint size B5 – B6)	260 mm
Weight (joint size B1 – B6)	29 kg

Cable type	
Type	all types
Diameter over isolation (joint size B1 – B4)	52 - 86 mm
Diameter over isolation (joint size B5 – B6)	86.1 - 122 mm
Range of overall cable diameter	150 mm

Cable screen connection for	
Wire screen	compression sleeve
Lead sheath	hose clamp or plumbing
Corrugated Al & Cu	hose clamp or plumbing
Screen transition	flat copper lead

Cross-bonding	
Screen take out	n/a
Bonding lead	n/a
Type of bonding lead	n/a
Bonding lead connection	n/a
Connectors with water barrier	n/a

Packing wooden box	
Gross weight 6 pcs A / B (approx.)	230 / 300 kg
Wooden box	standard
Installation instruction for each kit	yes

Installation	
Installation work	only by certified fitters
Installation temperature	min. 0 / max. + 55 °C
Site conditions	clean environment

Storage	
Conditions	clean and dry
Long-term storage temperature	min. 0 / max. + 25 °C
Shelf life items	2 years
Non-shelf life items	10 years
Expected service life after installation	40 years